

PNEUMATIC MOTORS

**Multi-vane air motors, from 2.5 HP to 7.8 HP
for a variety of applications on mining and quarry machines,
as well as on industrial and naval equipment**

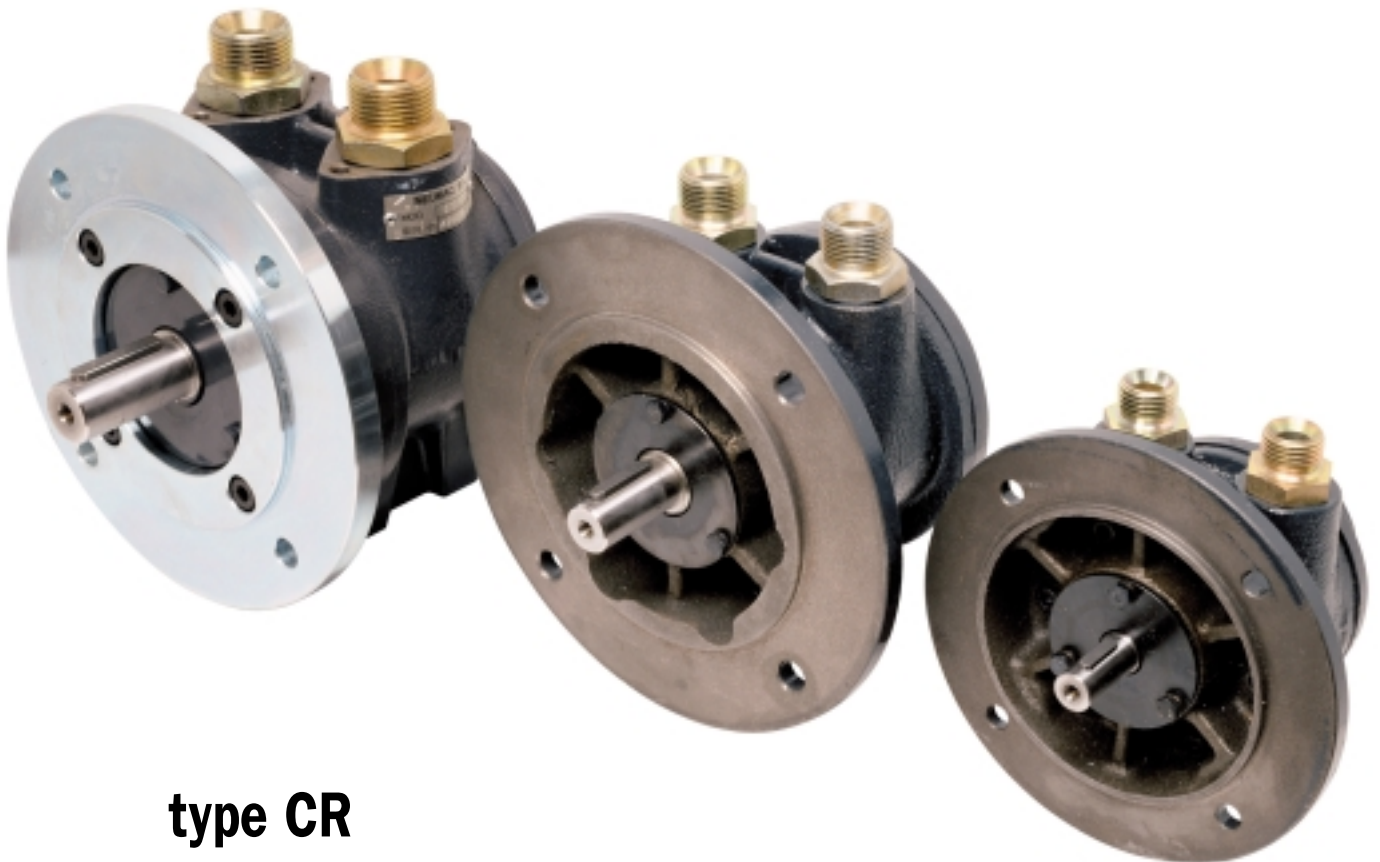

type CR

- Simple design, strong and economical
- Effective torque and reliable start
- Vanes permanently in working position
- Good efficiency at lower speed
- Reversible, same output in both senses
- Flange or foot mounting
- Adaptable to gear boxes and to control valves
- Versions with brake available

VANE AIR MOTORS TYPE CR

DIMENSIONS

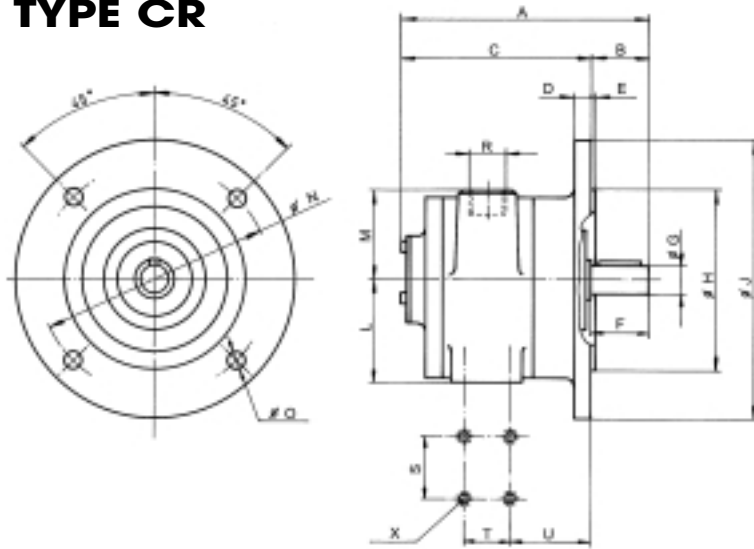

MODEL	A	B	C	D	E	F	G	H	J	L	M	N	O	R	S	T	U	X
2CR-30	139	30	109	9	3.5	30	14	110	160	52.5	49.5	130	9	GAS 1/2"	28	24	44	M.6
3CR-30	170	40	130	10		40	19	130	200	73.5	61.5	165	12	GAS 3/4"	46	34	53.2	
5CR-30	210	50	160	13		50	24		250	75	80		215	15	GAS 1"	67	51	57
6.5CR-30	234	60	174	13	4	60	28	180	250	75	80	215	15	GAS 1 1/4"	100	9.5	59.5	

TECHNICAL DATA (Air pressure = 6 bars)

MODEL	Max. power		Speed at máx. power (r/min)	Free speed (r/min)	Torque at max. power (Nm)	Min. starting torque (Nm)	Weight (Kg)	Air consumption at max. power (l/min)
	H.P.	kW						
2CR-30	2.41	1.77	4,000	8,000	4.25	4.15	4.8	2,600
3CR-30	3.82	2.81	3,000	6,000	8.50	7.80	9.5	3,800
5CR-30	6.22	4.6	3,000	6,000	14.50	14.10	15.0	6,100
6.5CR-30	7.64	5.62	2,500	5,000	24.22	23.50	17.0	7,500

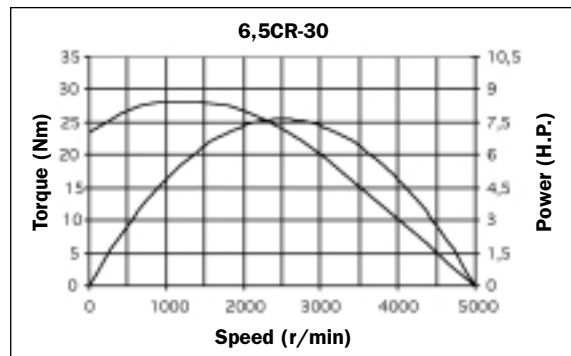
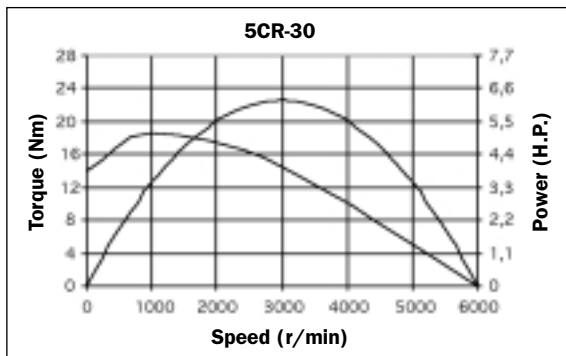
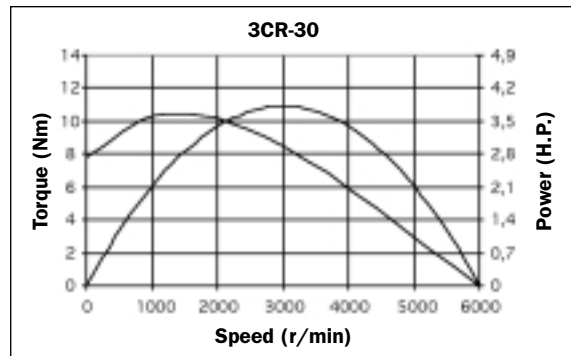
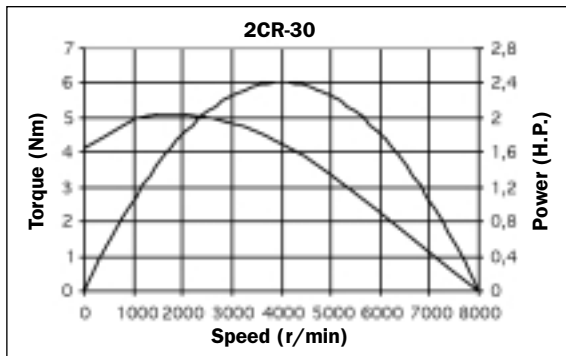

NEUMAC

**MECANIZADOS
SEGEDA, S.L.**

C/ Guadiana, 49
P.I. LOS CAÑOS
06300 Zafra (Badajoz)
España (Spain)

Teléfono (34) 924 56 30 31
Fax (34) 924 55 39 55
E-mail: neumac@neumac.es
www.neumac.es